

LEGEND

- STATE BOUNDARY
- COUNTY BOUNDARY
- STATE OR COUNTY LINE INDETERMINATE
- U.S. LAND TOWNSHIP LINE
- SECTION LINE
- PARK OR RESERVATION BOUNDARY
- PAVED STATE OR U.S. HIGHWAY
- DIVIDED HIGHWAY
- INTERSTATE HIGHWAY
- U.S. NUMBERED HIGHWAY
- STATE HIGHWAY
- PAVED LOCAL ROAD
- GRAVEL LOCAL ROAD
- GRADED & DRAINED LOCAL ROAD
- UNIMPROVED LOCAL ROAD
- INTERCHANGE
- RAILROAD AND NUMBER OF TRACKS USED BY RAILROAD STATION
- RAILROAD STATION
- GRADE CROSSING
- OVERPASS
- UNDERPASS
- HIGHWAY BRIDGE 100 FEET OR MORE IN LENGTH
- LEVEE OR DIKE
- LEVEE WITH ROAD
- MILEAGE BETWEEN POINTS
- LAKE, RESERVOIR OR POND
- LAKE, RESERVOIR OR POND WITH DAM
- WIDE RIVER OR STREAM
- DOCK, PIER OR LANDING
- MARSH OR SWAMP
- NAVIGABLE STREAM
- INTERMITTENT NAVIGATION
- SMALL STREAM
- DRAINAGE DITCH
- CORPORATE LIMITS AND ROADS THROUGH TOWN
- COUNTY SEAT
- OTHER CITIES AND TOWNS
- MUNICIPAL AIRPORT
- PRIVATE AIRFIELD
- FARM UNIT OR DWELLING
- GROUP OF CLOSELY SPACED DWELLINGS (CLUSTER NO. 1000000000)
- APARTMENT COMPLEX OR MOTEL
- CHURCH OR OTHER RELIGIOUS INSTITUTION
- SCHOOL
- CEMETERY
- CHURCH WITH CEMETERY ADJACENT
- BUSINESS ESTABLISHMENT
- FACTORY OR INDUSTRIAL PLANT-COTTON GIN
- GAS TANK
- GRAVEL PIT
- QUARRY
- NURSERY
- RADIO OR TELEVISION STATION AND CALL LETTERS
- AIRFIELD, GARAGE OR COUNTY GARAGE
- WEIGHT AND MEASURE STATION
- FIRE ENGINE HOUSE
- POWER SUBSTATION
- GRAIN ELEVATOR
- TRAILER PARK
- CAMP OR LODGE
- ATHLETIC FIELD OR AMUSEMENT PARK
- WATER SUPPLY STANDPIPE OR TANK
- SEWAGE DISPOSAL PLANT
- AUTO SALVAGE YARD
- GARBAGE DUMP OR SANITARY LANDFILL
- FAIRGROUND, RACE COURSE OR SPEEDWAY
- SCENIC HIGHWAY

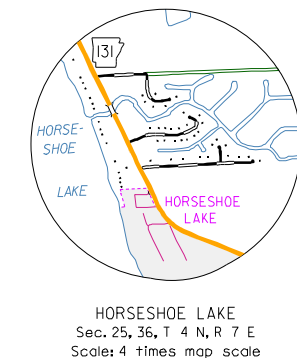
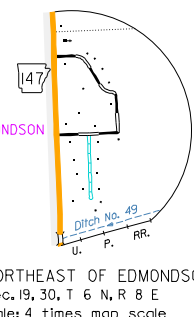
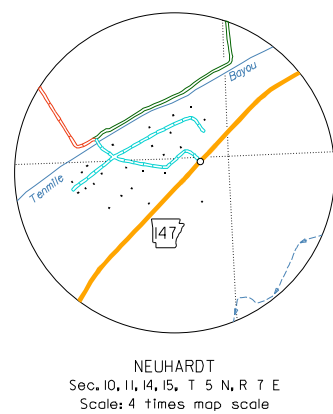
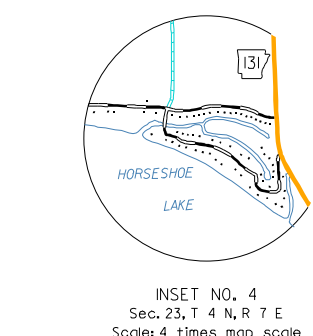
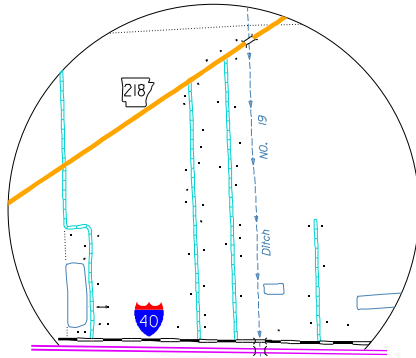
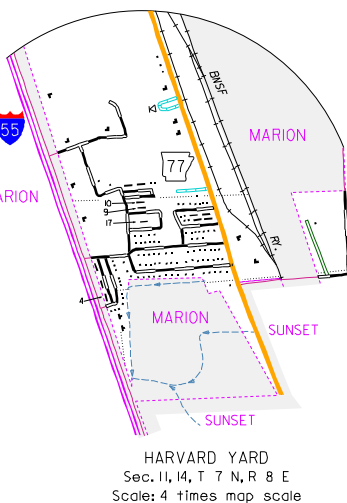
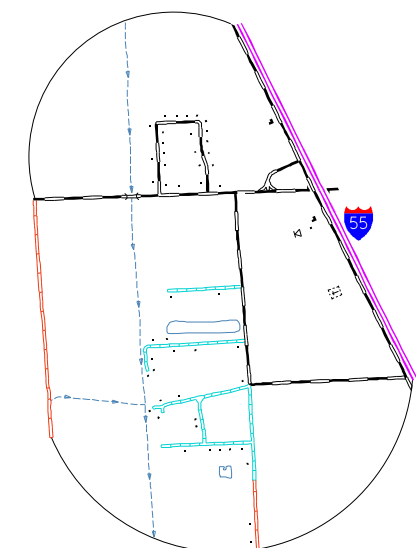
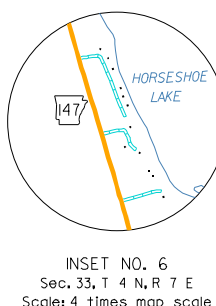
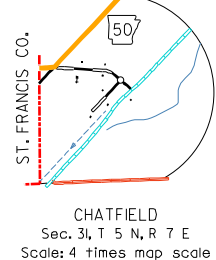
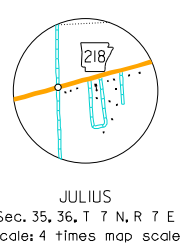
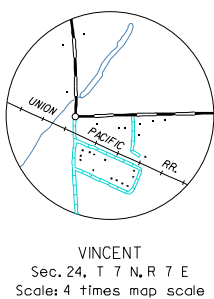
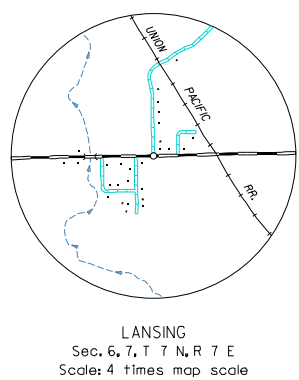
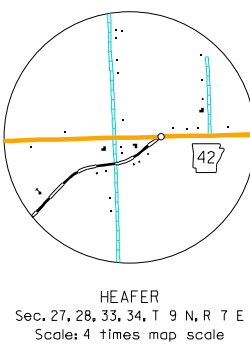
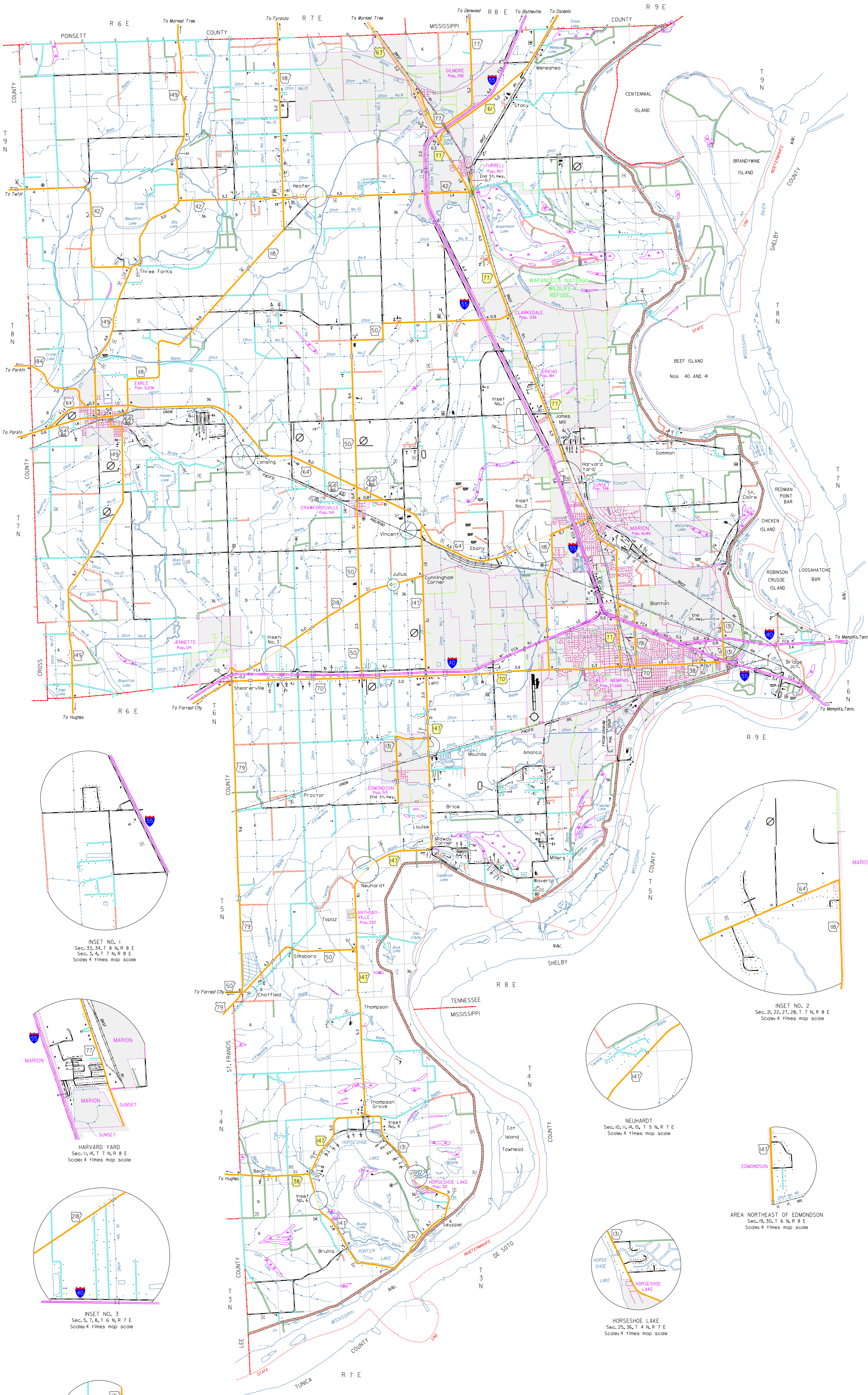

# GENERAL HIGHWAY MAP CRITTENDEN COUNTY ARKANSAS

PREPARED BY  
ARKANSAS STATE HIGHWAY AND TRANSPORTATION DEPARTMENT  
PLANNING AND RESEARCH DIVISION  
IN COOPERATION WITH  
U.S. DEPARTMENT OF TRANSPORTATION  
FEDERAL HIGHWAY ADMINISTRATION  
SCALE 1:62500  
MILES



Copies of this map are available  
at a nominal fee from the  
Arkansas State Highway and  
Transportation Department,  
P.O. Box 226-Little Rock, Ark. 72203

NOTES: Enlargements of all congested areas are four times  
map scale unless otherwise noted.  
Individual maps are available for all active incorporated cities.  
Area-637 square miles.  
Population-50,000 (2000 Census).  
Map issued 0-0-0-0, repliques map issued 0-25-99.  
Field Inventory 1974.  
Map revisions made from aerial photographs taken 04-08-00.  
Map compilation completed 09-0-06.  
County map produced using Computer Assisted Cartography.  
Map Revised 05-13-2005, reconnection of U.S. 64, Section 17 and 34, 147, Section 2, 3, 4, 5, 6, 7, 8, 9, 10, 11, 12, 13, 14, 15, 16, 17, 18, 19, 20, 21, 22, 23, 24, 25, 26, 27, 28, 29, 30, 31, 32, 33, 34, 35, 36, 37, 38, 39, 40, 41, 42, 43, 44, 45, 46, 47, 48, 49, 50, 51, 52, 53, 54, 55, 56, 57, 58, 59, 60, 61, 62, 63, 64, 65, 66, 67, 68, 69, 70, 71, 72, 73, 74, 75, 76, 77, 78, 79, 80, 81, 82, 83, 84, 85, 86, 87, 88, 89, 90, 91, 92, 93, 94, 95, 96, 97, 98, 99, 100.