

- LEGEND
- STATE BOUNDARY
 - COUNTY BOUNDARY
 - U. S. TOWNSHIP LINE
 - LAND SECTION LINE
 - PARK OR RESERVATION BOUNDARY
 - PAVED STATE OR U.S. HIGHWAY
 - U.S. NUMBERED HIGHWAY
 - STATE HIGHWAY
 - PAVED LOCAL ROAD
 - GRAVEL LOCAL ROAD
 - GRADED & DRAINED LOCAL ROAD
 - UNIMPROVED LOCAL ROAD
 - RAILROAD (ANY NUMBER OF TRACKS USED BY U.S. RAILROADS)
 - RAILROAD STATION
 - GRADE CROSSING
 - OVERPASS
 - UNDERPASS
 - HIGHWAY BRIDGE (OR FEET OR MORE IN LENGTH)
 - 0.5 MILEAGE BETWEEN POINTS
 - LAKE, RESERVOIR OR POND
 - LAKE, RESERVOIR OR POND WITH DAM
 - MARSH OR SWAMP
 - WIDE RIVER OR STREAM
 - DOCK, PIER OR LANDING
 - SMALL STREAM
 - DRAINAGE DITCH
 - CORPORATE LIMITS AND ROADS THROUGH TOWN
 - COUNTY SEAT
 - OTHER CITIES AND TOWNS
 - MUNICIPAL AIRPORT
 - PRIVATE AIRFIELD
 - FARM UNIT OR DWELLING
 - GROUP OF CLOSELY SPACED DWELLINGS (4+ NO FUTURE TOWN)
 - CHURCH OR OTHER RELIGIOUS INSTITUTION
 - SCHOOL
 - POST OFFICE + POST OFFICE AND BUSINESS
 - CEMETERY
 - CHURCH WITH CEMETERY ADJACENT
 - BUSINESS ESTABLISHMENT
 - FACTORY OR INDUSTRIAL PLANT-COTTON GIN
 - SAWMILL
 - OIL TANK
 - GRAVEL PIT
 - QUARRY
 - TOWN OR COMMUNITY HALL
 - RADIO OR TELEVISION STATION AND CALL LETTERS
 - FOREST RANGER STATION
 - POWER SUBSTATION
 - TRAILER PARK
 - PUMPING STATION, OIL OR GAS
 - GOLF COURSE OR COUNTRY CLUB
 - ATHLETIC FIELD OR AMUSEMENT PARK
 - SMALL PARK (0.25-2.0 ACRES, 10-100 FEET WIDE)
 - WATER SUPPLY STANDPIPE OR TANK
 - SEWAGE DISPOSAL PLANT
 - GARBAGE DUMP OR SANITARY LANDFILL
 - AUTO SALVAGE YARD
 - SCRAP METAL JUNK YARD
 - FARGROUND, RACE COURSE OR SPEEDWAY
 - RODDED ARENA
 - CHICKEN HOUSE OR OTHER LIVESTOCK
 - NURSERY
 - 82 SCENIC HIGHWAY

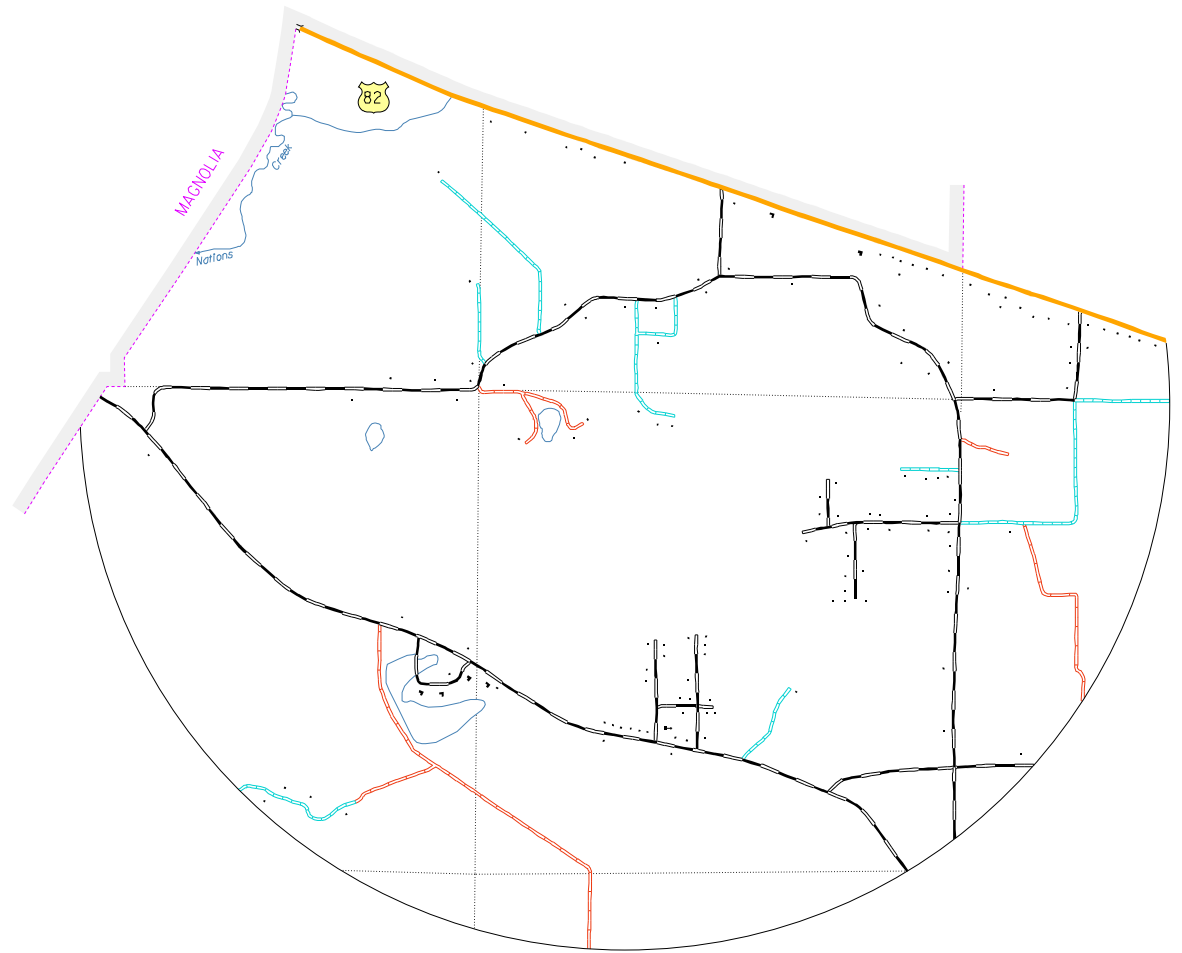

INSET NO. 1
Sec. 16, 17, 18, 19, 20, 21, 25, 30, T 17 S, R 20 W

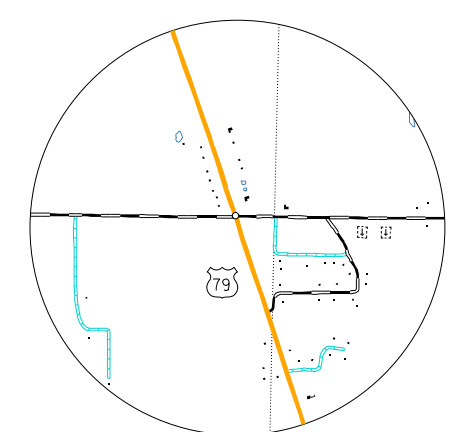

WALKER
Sec. 30, T 17 S, R 20 W
Sec. 25, T 17 S, R 21 W

GENERAL HIGHWAY MAP
COLUMBIA COUNTY
ARKANSAS

PREPARED BY
ARKANSAS STATE HIGHWAY AND TRANSPORTATION DEPARTMENT
PLANNING AND RESEARCH DIVISION
IN COOPERATION WITH
U.S. DEPARTMENT OF TRANSPORTATION
FEDERAL HIGHWAY ADMINISTRATION
SCALE 1:62,500

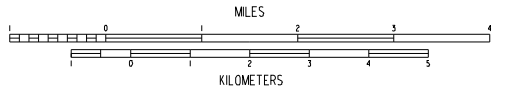

Copies of this map are available
at a nominal fee from the
Arkansas State Highway and
Transportation Department,
P.O. Box 226-1116 Rock, Ark. 72803

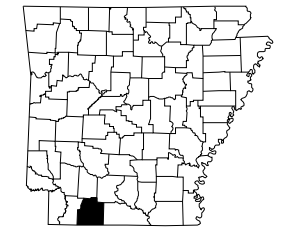

NOTE: Enlargements of all congested areas are five times
map scale unless otherwise noted.
Individual maps are available for all active incorporated cities.
Area: 164.34 square miles
Population: 25,603 (2000 Census)
Map issued 03-01-04, replaces map issued 06-11-98
Field Inventory 1915
Map revisions made from aerial photographs taken 04-08-00
Map compilation completed 03-04-04
County map produced using Computer Assisted Cartography.
Map Revised 01-31-07, added Falcon Springs Natural Area boundary and FALCON
Map Revised 02-04-07, changed the city limits on the East side of the city, Lab
Map Revised 10-01-09, city limit change in Magnolia, LA

Polyconic Projection-North American Datum